

## Base Plate Linear Actuator Connectors

Aluminum / Stainless Steel, with 4 Mounting Holes

### SPECIFICATION

#### Identification no.

- No. **2**: With stainless steel socket cap screw DIN 912

Aluminum

Powder coated

Black, RAL 9005, textured finish **SW**

Stainless Steel AISI CF-8 **NI**

Matte shot-blasted

Only with sleeve bearing

Sleeve bearing

Plastic (PTFE)

Socket cap screws DIN 912

Stainless steel AISI 304

Hex nuts DIN 985

Stainless steel AISI 304

Self-locking via polyamide ring



### INFORMATION

Base plate linear actuator connectors GN 162.1 are based on base plate connector clamps. The additionally provided fastening holes are used to connect to the drive key of a linear actuator. Bore with the designation „G“ are equipped with sleeve bearings.

With the screw location **z**, the play of the guide bores  $d_1$  can be adjusted or the linear actuator connectors can be clamped after adjustment.

### TECHNICAL INFORMATION

- Plastic Characteristics (see page A2)

- Stainless Steel Characteristics (see page A26)

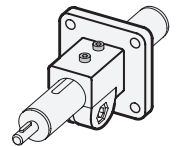
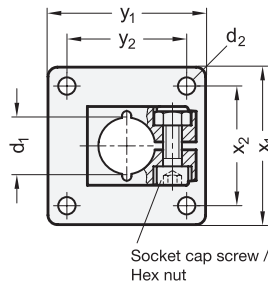
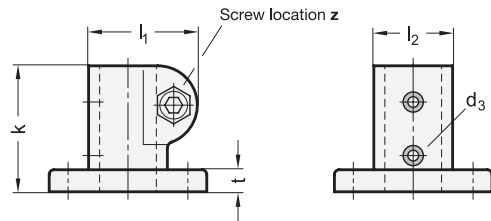

#### GN 162.1-AL

Description	d1 Bore without sleeve bearing	d1 Bore with sleeve bearing	d2	d3 Mounting screws on the drive key	k Clamping length	l1	l2	t	x1	x2	y1	y2	z Screw location	⚖
GN 162.1-G18-2-SW	-	G 18	5.5	M 3	40	34.5	25	7	50	38	50	38	M6-20	79
GN 162.1-B18-2-SW	B 18	-	5.5	M 3	40	34.5	25	7	50	38	50	38	M6-20	75

#### GN 162.1-NI

**STAINLESS STEEL**

Description	d1 Bore with sleeve bearing	d2	d3 Mounting screws on the drive key	k Clamping length	l1	l2	t	x1	x2	y1	y2	z Screw location	⚖
GN 162.1-G18-2-NI	G 18	5.5	M 3	40	34.5	25	7	50	38	50	38	M6-20	79